



Weather Strip Series Detailed Introduction

Version: March 2025

www.qimeida.cn

info@qimeida.cn



PU包覆密封条-自粘式:KMT-M0642

PU Foam sealing strip- Self Adhesive

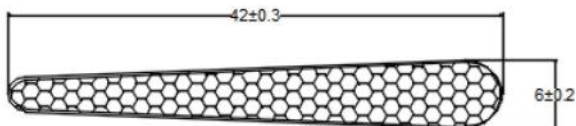

材料:

奇美达包覆式密封条,选用高回弹的聚氨酯泡沫内芯,高韧性聚乙烯外膜,以及高粘度,易撕拉的优质3M背胶制成。

Material:

CHIMEDA PU foam sealing strip, uses high-resilience polyurethane foam inner core, high-toughness polyethylene outer film, and is made of 3M backing adhesive with high-viscosity and easy-to-tear.

性能:

10%以下的压缩变形
-40℃至90℃的耐候性
户外20年以上的耐老化性
模仿门窗开关50万次外形无明显变化的耐疲劳性
提高门窗35%的隔音性能

Performance:

It features compression deformation below 10%
Weather resistance from -40 °C to 90 °C
Outdoor aging resistance for more than 20 years
Fatigue resistance with no obvious change in shape after 500000 times of imitated open-close of doors and windows
Improve the sound insulation performance of doors and windows by 35%

颜色:

黑色、白色、灰色、棕色、米黄、红色

Color:

Black /White /Grey /Brown /Beige /Red

包装:

- 1.卷式包装, 2-3卷/箱
- 2.条式包装, 根据客户长度要求截根, 装箱

Packing:

1. Roll packing, 2-3 rolls/carton
- 2.Strip packing, cut to length according to customer requirements and pack into cartons



PU包覆密封条-自粘式:KMT-M0618

PU Foam sealing strip- Self Adhesive

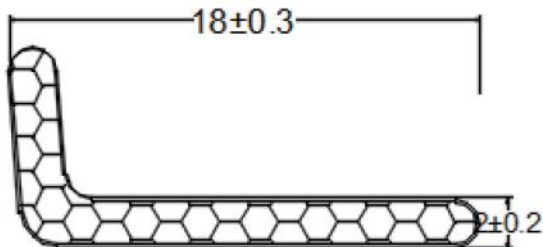

材料:

奇美达包覆式密封条,选用高回弹的聚氨酯泡沫内芯,高韧性聚乙烯外膜,以及高粘度,易撕拉的优质3M背胶制成。

Material:

CHIMEDA PU foam sealing strip, uses high-resilience polyurethane foam inner core, high-toughness polyethylene outer film, and is made of 3M backing adhesive with high-viscosity and easy-to-tear.

性能:

10%以下的压缩变形
-40℃至90℃的耐候性
户外20年以上的耐老化性
模仿门窗开关50万次外形无明显变化的耐疲劳性
提高门窗35%的隔音性能

Performance:

It features compression deformation below 10%
Weather resistance from -40 °C to 90 °C
Outdoor aging resistance for more than 20 years
Fatigue resistance with no obvious change in shape after 500000 times of imitated open-close of doors and windows
Improve the sound insulation performance of doors and windows by 35%

颜色:

黑色、白色、灰色、棕色、米黄、红色

Color:

Black /White /Grey /Brown /Beige /Red

包装:

- 1.卷式包装, 2-3卷/箱
- 2.条式包装, 根据客户长度要求截根, 装箱

Packing:

1. Roll packing, 2-3 rolls/carton
- 2.Strip packing, cut to length according to customer requirements and pack into cartons

材料:

奇美达包覆式密封条, 选用高回弹的聚氨酯泡沫内芯, 高韧性聚乙烯外膜, PP骨架及TPV塑料倒钩完美结合。

Material:

CHIMEDA PU foam sealing strip, use high-resilience polyurethane foam inner core, high-toughness polyethylene outer film and is perfectly combined with PP skeleton and TPV plastic barbs.

性能:

10%以下的压缩变形
-40°C至90°C的耐候性
户外20年以上的耐老化性
模仿门窗开关50万次外形无明显变化的耐疲劳性
提高门窗35%的隔音性能

Performance:

It features compression deformation below 10%
Weather resistance from -40 °C to 90 °C
Outdoor aging resistance for more than 20 years
Fatigue resistance with no obvious change in shape after 500000 times of imitated open-close of doors and windows
Improve the sound insulation performance of doors and windows by 35%

PU包覆密封条-卡槽式:KMT-M0511

PU Foam sealing strip- slot type

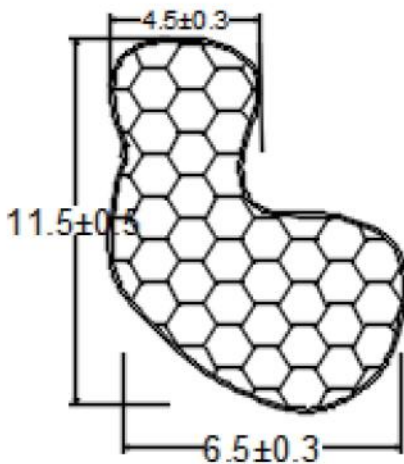

颜色:

黑色、白色、灰色、棕色、米黄、红色

Color:

Black /White /Grey /Brown /Beige /Red

包装:

- 1.卷式包装, 2-3卷/箱
- 2.条式包装, 根据客户长度要求截根, 装箱

Packing:

1. Roll packing, 2-3 rolls/carton
- 2.Strip packing, cut to length according to customer requirements and pack into cartons



PU包覆密封条-卡槽式:KMT-M0509

PU Foam sealing strip-slot type

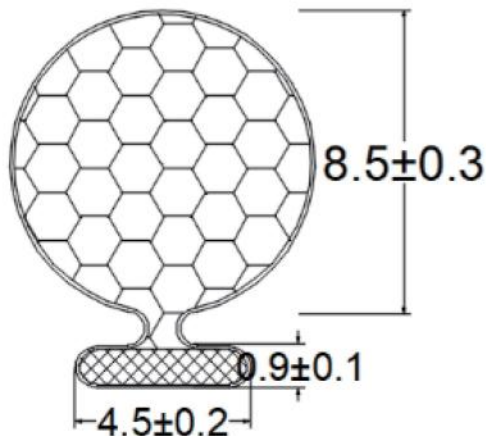

材料:

奇美达包覆式密封条, 选用高回弹的聚氨酯泡沫内芯, 高韧性聚乙烯外膜, PP骨架及TPV塑料倒钩完美结合。

Material:

CHIMEDA PU foam sealing strip, use high-resilience polyurethane foam inner core, high-toughness polyethylene outer film and is perfectly combined with PP skeleton and TPV plastic barbs.

性能:

10%以下的压缩变形
-40℃至90℃的耐候性
户外20年以上的耐老化性
模仿门窗开关50万次外形无明显变化的耐疲劳性
提高门窗35%的隔音性能

Performance:

It features compression deformation below 10%
Weather resistance from -40 °C to 90 °C
Outdoor aging resistance for more than 20 years
Fatigue resistance with no obvious change in shape after 500000 times of imitated open-close of doors and windows
Improve the sound insulation performance of doors and windows by 35%

颜色:

黑色、白色、灰色、棕色、米黄、红色

Color:

Black /White /Grey /Brown /Beige /Red

包装:

- 1.卷式包装, 2-3卷/箱
- 2.条式包装, 根据客户长度要求截根, 装箱

Packing:

1. Roll packing, 2-3 rolls/carton
- 2.Strip packing, cut to length according to customer requirements and pack into cartons

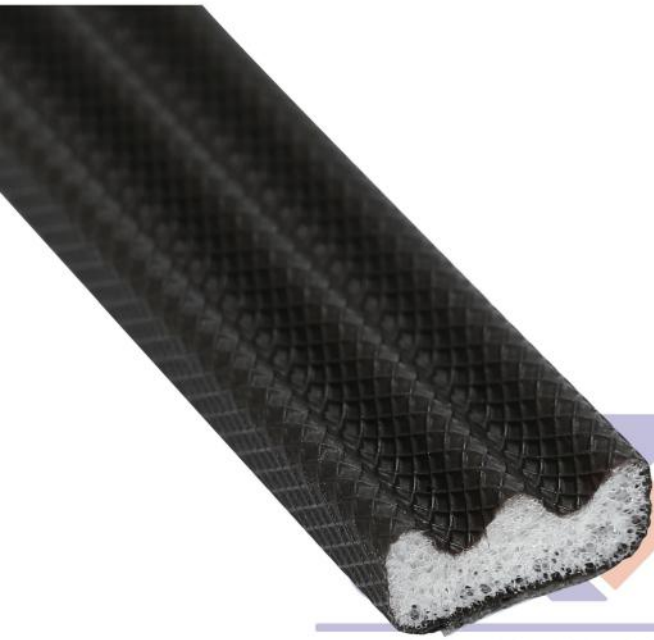

PU包覆密封条-自粘式:KMT-M0409

PU Foam sealing strip- Self Adhesive

材料:

奇美达包覆式密封条,选用高回弹的聚氨酯泡沫内芯,高韧性聚乙烯外膜,以及高粘度,易撕拉的优质3M背胶制成。

Material:

CHIMEDA PU foam sealing strip, uses high-resilience polyurethane foam inner core, high-toughness polyethylene outer film, and is made of 3M backing adhesive with high-viscosity and easy-to-tear.

性能:

10%以下的压缩变形
-40°C至90°C的耐候性
户外20年以上的耐老化性
模仿门窗开关50万次外形无明显变化的耐疲劳性
提高门窗35%的隔音性能

Performance:

It features compression deformation below 10%
Weather resistance from -40 °C to 90 °C
Outdoor aging resistance for more than 20 years
Fatigue resistance with no obvious change in shape after 500000 times of imitated open-close of doors and windows
Improve the sound insulation performance of doors and windows by 35%

颜色:

黑色、白色、灰色、棕色、米黄、红色

Color:

Black /White /Grey /Brown /Beige /Red

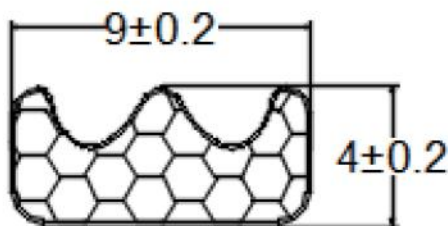

包装:

- 1.卷式包装, 2-3卷/箱
- 2.条式包装, 根据客户长度要求截根, 装箱

Packing:

1. Roll packing, 2-3 rolls/carton
- 2.Strip packing, cut to length according to customer requirements and pack into cartons

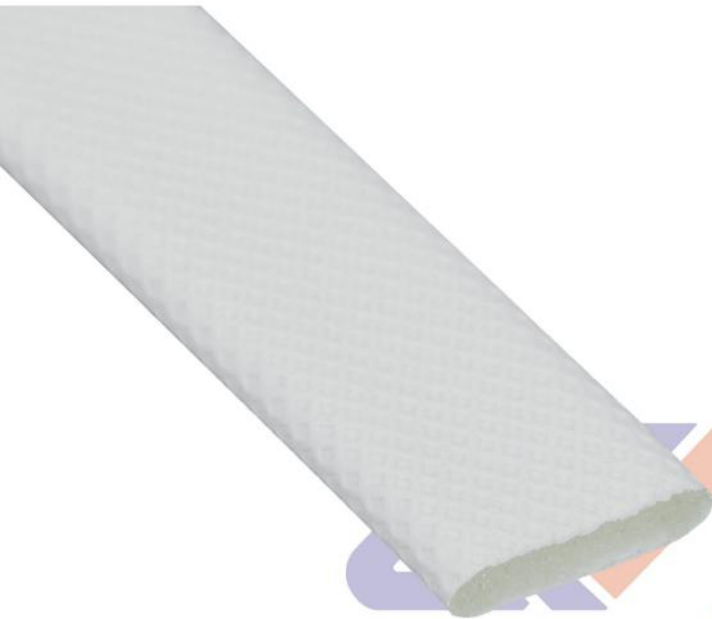

PU包覆密封条-自粘式:KMT-M0209

PU Foam sealing strip- Self Adhesive

材料:

奇美达包覆式密封条,选用高回弹的聚氨酯泡沫内芯,高韧性聚乙烯外膜,以及高粘度,易撕拉的优质3M背胶制成。

Material:

CHIMEDA PU foam sealing strip, uses high-resilience polyurethane foam inner core, high-toughness polyethylene outer film, and is made of 3M backing adhesive with high-viscosity and easy-to-tear.

性能:

10%以下的压缩变形
-40°C至90°C的耐候性
户外20年以上的耐老化性
模仿门窗开关50万次外形无明显变化的耐疲劳性
提高门窗35%的隔音性能

Performance:

It features compression deformation below 10%
Weather resistance from -40 °C to 90 °C
Outdoor aging resistance for more than 20 years
Fatigue resistance with no obvious change in shape after 500000 times of imitated open-close of doors and windows
Improve the sound insulation performance of doors and windows by 35%

颜色:

黑色、白色、灰色、棕色、米黄、红色

Color:

Black /White /Grey /Brown /Beige /Red

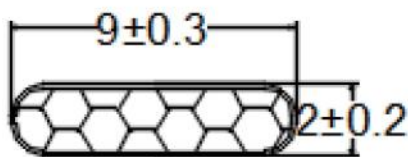

包装:

- 1.卷式包装, 2-3卷/箱
- 2.条式包装, 根据客户长度要求截根, 装箱

Packing:

1. Roll packing, 2-3 rolls/carton
- 2.Strip packing, cut to length according to customer requirements and pack into cartons



三复合密封条:KMT-YT001

Three types of composite material sealing strips

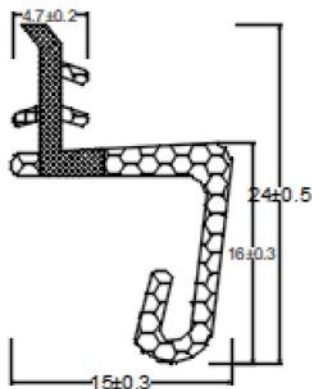

材料:

奇美达三复合密封条在碰撞面做了外涂层处理,材料选用进口涂层材料,材质基材硬质部分为改性PP(硬度高),软质材质为三元乙丙橡胶TPV。

Material:

CHIMEDA three types of composite sealing strips have undergone external coating treatment on the collision surface, using imported coating materials. The base material part uses modified PP (high hardness), and the soft parts uses TPV material.

性能:

对于长期开关门的碰撞,表面涂层有非常优秀的耐磨防划伤效果。涂层处理以后,表面触感爽滑,在高温情况下,不会有其他材质的黏连。

此工艺借鉴于汽车密封条工艺特点,有着优良的耐磨性、耐候性、持久的回弹性。

Performance:

For long-term door opening and closing collision tests, the surface coating shows excellent wear resistance and anti-scratch effects. After coating, the surface feels matte and will not stick to other materials at high temperatures.

This process draws on the characteristics of the automobile sealing strip process, and has excellent wear resistance, weather resistance, and long-lasting resilience.

颜色:

黑色、白色、灰色、棕色、米黄、红色

Color:

Black /White /Grey /Brown /Beige /Red

包装:

- 1.卷式包装,2-3卷/箱
- 2.条式包装,根据客户长度要求截根,装箱

Packing:

1. Roll packing, 2-3 rolls/carton
2. Strip packing, cut to length according to customer requirements and pack into cartons



三复合密封条:KMT-ES181

Three types of composite material sealing strips

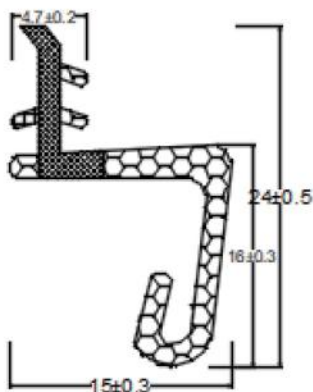

材料:

奇美达三复合密封条在碰撞面做了外涂层处理,材料选用进口涂层材料,材质基材硬质部分为改性PP(硬度高),软质材质为三元乙丙橡胶TPV。

Material:

CHIMEDA three types of composite sealing strips have undergone external coating treatment on the collision surface, using imported coating materials. The base material part uses modified PP (high hardness), and the soft parts uses TPV material.

性能:

对于长期开关门的碰撞,表面涂层有非常优秀的耐磨防划伤效果,涂层处理以后,表面触感爽滑,在高温情况下,不会有其他材质的黏连。

此工艺借鉴于汽车密封条工艺特点,有着优良的耐磨性、耐候性、持久的回弹性。

Performance:

For long-term door opening and closing collision tests, the surface coating shows excellent wear resistance and anti-scratch effects. After coating, the surface feels matte and will not stick to other materials at high temperatures.

This process draws on the characteristics of the automobile sealing strip process, and has excellent wear resistance, weather resistance, and long-lasting resilience.

颜色:

黑色、白色、灰色、棕色、米黄、红色

Color:

Black /White /Grey /Brown /Beige /Red

包装:

- 1.卷式包装,2-3卷/箱
- 2.条式包装,根据客户长度要求截根,装箱

Packing:

1. Roll packing, 2-3 rolls/carton
2. Strip packing, cut to length according to customer requirements and pack into cartons

材料:

奇美达TPE密封条, 选用环保、无毒、无污染的熱塑性弹性体TPE材料。

Material:

CHIMEDA TPE sealing strip, is made of environmentally friendly, non-toxic, and pollution-free thermoplastic elastomer TPE material

性能:

具有优良的耐低温、耐高温性
直接挤出成型, 不用硫化
触感柔软、表面质量优异
对环境及设备无伤害

Performance:

Has excellent low temperature resistance and high temperature resistance
Direct extrusion molding without vulcanization
Soft touch, Excellent surface quality
No harm to the environment and equipment

TPE密封条: KMT-TF1029

TPE Sealing strip

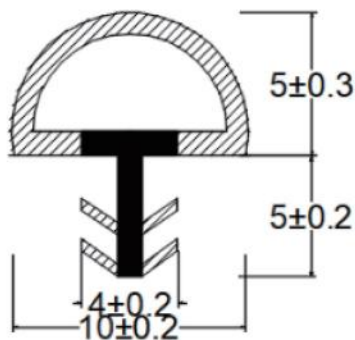

颜色:

黑色、白色、灰色、棕色、米黄、红色

Color:

Black /White /Grey /Brown /Beige /Red

包装:

1.卷式包装, 2-3卷/箱

Packing:

Roll packaging, 2-3 rolls/carton

材料:

奇美达TPE密封条, 选用环保、无毒、无污染的熱塑性弹性体TPE材料。

Material:

CHIMEDA TPE sealing strip, is made of environmentally friendly, non-toxic, and pollution-free thermoplastic elastomer TPE material

性能:

具有优良的耐低温、耐高温性
直接挤出成型, 不用硫化
触感柔软、表面质量优异
对环境及设备无伤害

Performance:

Has excellent low temperature resistance and high temperature resistance
Direct extrusion molding without vulcanization
Soft touch, Excellent surface quality
No harm to the environment and equipment

TPE密封条: KMT-T1030

TPE Sealing strip

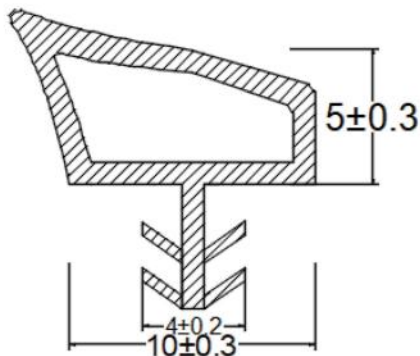

颜色:

黑色、白色、灰色、棕色、米黄、红色

Color:

Black /White /Grey /Brown /Beige /Red

包装:

1.卷式包装, 2-3卷/箱

Packing:

Roll packaging, 2-3 rolls/carton

材料:

奇美达TPE密封条, 选用环保、无毒、无污染的熱塑性弹性体TPE材料。

Material:

CHIMEDA TPE sealing strip, is made of environmentally friendly, non-toxic, and pollution-free thermoplastic elastomer TPE material

性能:

具有优良的耐低温、耐高温性
直接挤出成型, 不用硫化
触感柔软、表面质量优异
对环境及设备无伤害

Performance:

Has excellent low temperature resistance and high temperature resistance
Direct extrusion molding without vulcanization
Soft touch, Excellent surface quality
No harm to the environment and equipment

TPE密封条: KMT-TF1024

TPE Sealing strip

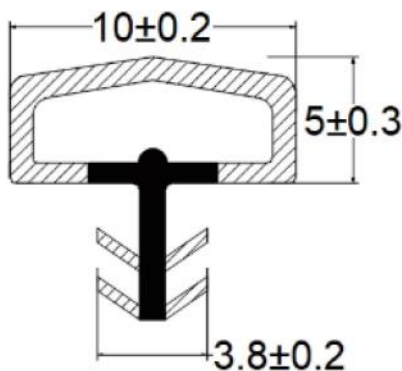

颜色:

黑色、白色、灰色、棕色、米黄、红色

Color:

Black /White /Grey /Brown /Beige /Red

包装:

1.卷式包装, 2-3卷/箱

Packing:

Roll packaging, 2-3 rolls/carton

材料:

奇美达包覆式密封条, 选用高回弹的聚氨酯泡沫内芯, 高韧性聚乙烯外膜, PP骨架及TPV塑料倒钩完美结合。

Material:

CHIMEDA PU foam sealing strip, use high-resilience polyurethane foam inner core, high-toughness polyethylene outer film and is perfectly combined with PP skeleton and TPV plastic barbs.

性能:

10%以下的压缩变形
-40°C至90°C的耐候性
户外20年以上的耐老化性
模仿门窗开关50万次外形无明显变化的耐疲劳性
提高门窗35%的隔音性能

Performance:

It features compression deformation below 10%
Weather resistance from -40 °C to 90 °C
Outdoor aging resistance for more than 20 years
Fatigue resistance with no obvious change in shape after 500000 times of imitated open-close of doors and windows
Improve the sound insulation performance of doors and windows by 35%

PU包覆密封条-卡槽式:KMT-C0901
PU Foam sealing strip- slot type

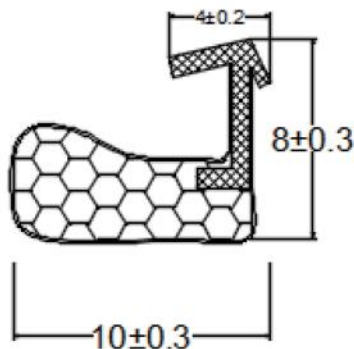

颜色:

黑色、白色、灰色、棕色、米黄、红色

Color:

Black /White /Grey /Brown /Beige /Red

包装:

- 1.卷式包装, 2-3卷/箱
- 2.条式包装, 根据客户长度要求截根, 装箱

Packing:

1. Roll packing, 2-3 rolls/carton
- 2.Strip packing, cut to length according to customer requirements and pack into cartons



PU包覆密封条-卡槽式:KMT-C0802
PU Foam sealing strip- slot type

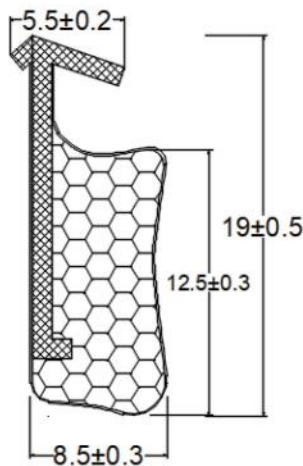

材料:

奇美达包覆式密封条, 选用高回弹的聚氨酯泡沫内芯, 高韧性聚乙烯外膜, PP骨架及TPV塑料倒钩完美结合。

Material:

CHIMEDA PU foam sealing strip, use high-resilience polyurethane foam inner core, high-toughness polyethylene outer film and is perfectly combined with PP skeleton and TPV plastic barbs.

性能:

10%以下的压缩变形
-40℃至90℃的耐候性
户外20年以上的耐老化性
模仿门窗开关50万次外形无明显变化的耐疲劳性
提高门窗35%的隔音性能

Performance:

It features compression deformation below 10%
Weather resistance from -40 °C to 90 °C
Outdoor aging resistance for more than 20 years
Fatigue resistance with no obvious change in shape after 500000 times of imitated open-close of doors and windows
Improve the sound insulation performance of doors and windows by 35%

颜色:

黑色、白色、灰色、棕色、米黄、红色

Color:

Black /White /Grey /Brown /Beige /Red

包装:

- 1.卷式包装, 2-3卷/箱
- 2.条式包装, 根据客户长度要求截根, 装箱

Packing:

1. Roll packing, 2-3 rolls/carton
- 2.Strip packing, cut to length according to customer requirements and pack into cartons

材料:

奇美达包覆式密封条, 选用高回弹的聚氨酯泡沫内芯, 高韧性聚乙烯外膜, PP骨架及TPV塑料倒钩完美结合。

Material:

CHIMEDA PU foam sealing strip, use high-resilience polyurethane foam inner core, high-toughness polyethylene outer film and is perfectly combined with PP skeleton and TPV plastic barbs.

性能:

10%以下的压缩变形
-40°C至90°C的耐候性
户外20年以上的耐老化性
模仿门窗开关50万次外形无明显变化的耐疲劳性
提高门窗35%的隔音性能

Performance:

It features compression deformation below 10%
Weather resistance from -40 °C to 90 °C
Outdoor aging resistance for more than 20 years
Fatigue resistance with no obvious change in shape after 500000 times of imitated open-close of doors and windows
Improve the sound insulation performance of doors and windows by 35%

PU包覆密封条-卡槽式:KMT-M1501

PU Foam sealing strip- slot type

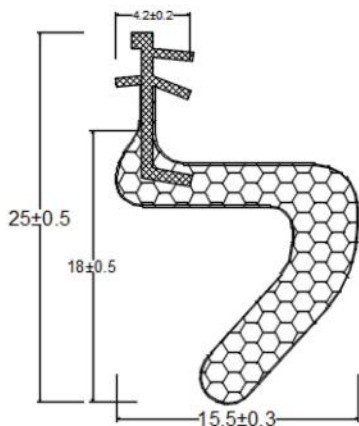

颜色:

黑色、白色、灰色、棕色、米黄、红色

Color:

Black /White /Grey /Brown /Beige /Red

包装:

- 1.卷式包装, 2-3卷/箱
- 2.条式包装, 根据客户长度要求截根, 装箱

Packing:

1. Roll packing, 2-3 rolls/carton
- 2.Strip packing, cut to length according to customer requirements and pack into cartons

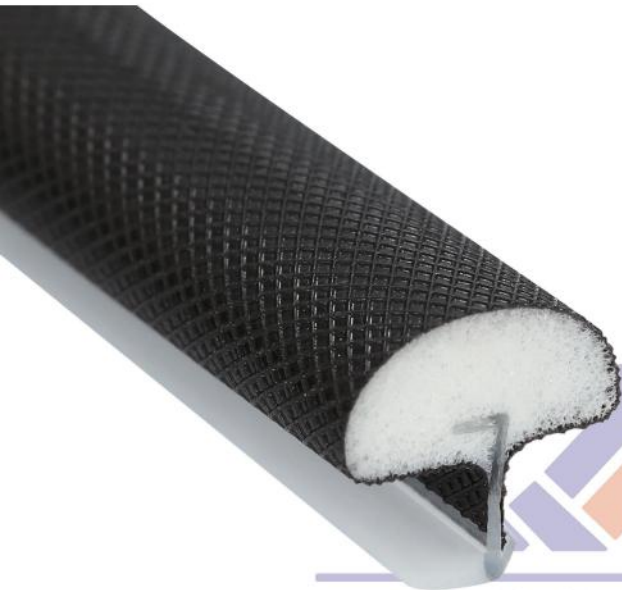

PU包覆密封条-卡槽式:KMT-M1029

PU Foam sealing strip- slot type

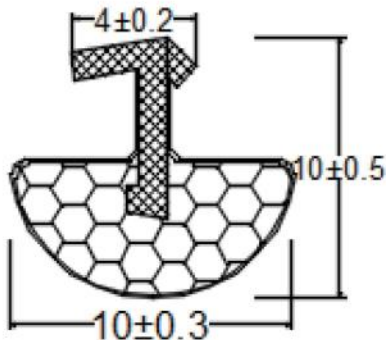

材料:

奇美达包覆式密封条, 选用高回弹的聚氨酯泡沫内芯, 高韧性聚乙烯外膜, PP骨架及TPV塑料倒钩完美结合。

Material:

CHIMEDA PU foam sealing strip, use high-resilience polyurethane foam inner core, high-toughness polyethylene outer film and is perfectly combined with PP skeleton and TPV plastic barbs.

性能:

10%以下的压缩变形
-40℃至90℃的耐候性
户外20年以上的耐老化性
模仿门窗开关50万次外形无明显变化的耐疲劳性
提高门窗35%的隔音性能

Performance:

It features compression deformation below 10%
Weather resistance from -40 °C to 90 °C
Outdoor aging resistance for more than 20 years
Fatigue resistance with no obvious change in shape after 500000 times of imitated open-close of doors and windows
Improve the sound insulation performance of doors and windows by 35%

颜色:

黑色、白色、灰色、棕色、米黄、红色

Color:

Black /White /Grey /Brown /Beige /Red

包装:

- 1.卷式包装, 2-3卷/箱
- 2.条式包装, 根据客户长度要求截根, 装箱

Packing:

1. Roll packing, 2-3 rolls/carton
- 2.Strip packing, cut to length according to customer requirements and pack into cartons

材料:

奇美达包覆式密封条, 选用高回弹的聚氨酯泡沫内芯, 高韧性聚乙烯外膜, PP骨架及TPV塑料倒钩完美结合。

Material:

CHIMEDA PU foam sealing strip, use high-resilience polyurethane foam inner core, high-toughness polyethylene outer film and is perfectly combined with PP skeleton and TPV plastic barbs.

性能:

10%以下的压缩变形
-40°C至90°C的耐候性
户外20年以上的耐老化性
模仿门窗开关50万次外形无明显变化的耐疲劳性
提高门窗35%的隔音性能

Performance:

It features compression deformation below 10%
Weather resistance from -40 °C to 90 °C
Outdoor aging resistance for more than 20 years
Fatigue resistance with no obvious change in shape after 500000 times of imitated open-close of doors and windows
Improve the sound insulation performance of doors and windows by 35%

PU包覆密封条-卡槽式:KMT-M1025

PU Foam sealing strip- slot type

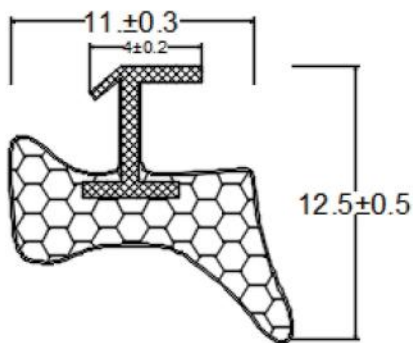

颜色:

黑色、白色、灰色、棕色、米黄、红色

Color:

Black /White /Grey /Brown /Beige /Red

包装:

- 1.卷式包装, 2-3卷/箱
- 2.条式包装, 根据客户长度要求截根, 装箱

Packing:

1. Roll packing, 2-3 rolls/carton
- 2.Strip packing, cut to length according to customer requirements and pack into cartons



PU包覆密封条-卡槽式:KMT-M1024

PU Foam sealing strip- slot type

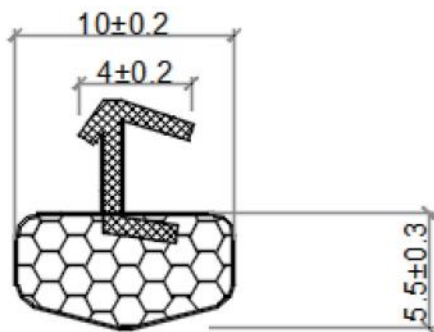

材料:

奇美达包覆式密封条, 选用高回弹的聚氨酯泡沫内芯, 高韧性聚乙烯外膜, PP骨架及TPV塑料倒钩完美结合。

Material:

CHIMEDA PU foam sealing strip, use high-resilience polyurethane foam inner core, high-toughness polyethylene outer film and is perfectly combined with PP skeleton and TPV plastic barbs.

性能:

10%以下的压缩变形
-40℃至90℃的耐候性
户外20年以上的耐老化性
模仿门窗开关50万次外形无明显变化的耐疲劳性
提高门窗35%的隔音性能

Performance:

It features compression deformation below 10%
Weather resistance from -40 °C to 90 °C
Outdoor aging resistance for more than 20 years
Fatigue resistance with no obvious change in shape after 500000 times of imitated open-close of doors and windows
Improve the sound insulation performance of doors and windows by 35%

颜色:

黑色、白色、灰色、棕色、米黄、红色

Color:

Black /White /Grey /Brown /Beige /Red

包装:

- 1.卷式包装, 2-3卷/箱
- 2.条式包装, 根据客户长度要求截根, 装箱

Packing:

1. Roll packing, 2-3 rolls/carton
- 2.Strip packing, cut to length according to customer requirements and pack into cartons

材料:

奇美达包覆式密封条, 选用高回弹的聚氨酯泡沫内芯, 高韧性聚乙烯外膜, PP骨架及TPV塑料倒钩完美结合。

Material:

CHIMEDA PU foam sealing strip, use high-resilience polyurethane foam inner core, high-toughness polyethylene outer film and is perfectly combined with PP skeleton and TPV plastic barbs.

性能:

10%以下的压缩变形
-40°C至90°C的耐候性
户外20年以上的耐老化性
模仿门窗开关50万次外形无明显变化的耐疲劳性
提高门窗35%的隔音性能

Performance:

It features compression deformation below 10%
Weather resistance from -40 °C to 90 °C
Outdoor aging resistance for more than 20 years
Fatigue resistance with no obvious change in shape after 500000 times of imitated open-close of doors and windows
Improve the sound insulation performance of doors and windows by 35%

PU包覆密封条-卡槽式:KMT-M1021

PU Foam sealing strip- slot type

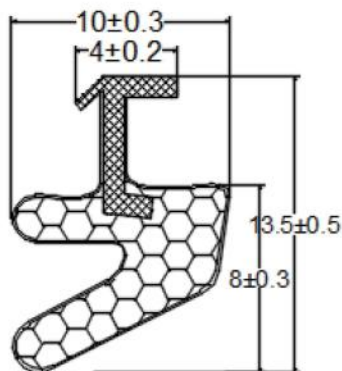

颜色:

黑色、白色、灰色、棕色、米黄、红色

Color:

Black /White /Grey /Brown /Beige /Red

包装:

- 1.卷式包装, 2-3卷/箱
- 2.条式包装, 根据客户长度要求截根, 装箱

Packing:

1. Roll packing, 2-3 rolls/carton
- 2.Strip packing, cut to length according to customer requirements and pack into cartons

材料:

奇美达包覆式密封条, 选用高回弹的聚氨酯泡沫内芯, 高韧性聚乙烯外膜, PP骨架及TPV塑料倒钩完美结合。

Material:

CHIMEDA PU foam sealing strip, use high-resilience polyurethane foam inner core, high-toughness polyethylene outer film and is perfectly combined with PP skeleton and TPV plastic barbs.

性能:

10%以下的压缩变形
-40℃至90℃的耐候性
户外20年以上的耐老化性
模仿门窗开关50万次外形无明显变化的耐疲劳性
提高门窗35%的隔音性能

Performance:

It features compression deformation below 10%
Weather resistance from -40 °C to 90 °C
Outdoor aging resistance for more than 20 years
Fatigue resistance with no obvious change in shape after 500000 times of imitated open-close of doors and windows
Improve the sound insulation performance of doors and windows by 35%

PU包覆密封条-卡槽式:KMT-DS7

PU Foam sealing strip- slot type

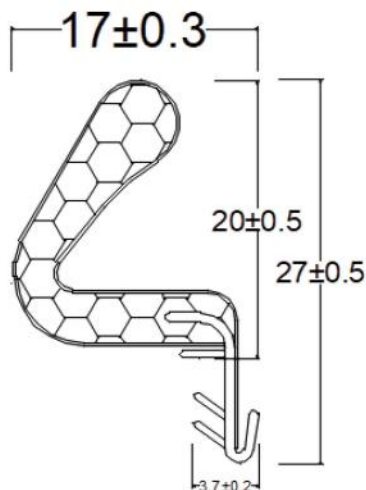

颜色:

黑色、白色、灰色、棕色、米黄、红色

Color:

Black /White /Grey /Brown /Beige /Red

包装:

- 1.卷式包装, 2-3卷/箱
- 2.条式包装, 根据客户长度要求截根, 装箱

Packing:

1. Roll packing, 2-3 rolls/carton
- 2.Strip packing, cut to length according to customer requirements and pack into cartons



PU包覆密封条-卡槽式:KMT-M45

PU Foam sealing strip- slot type

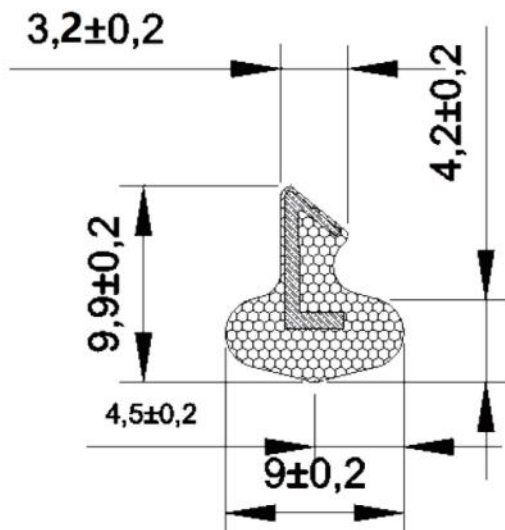

材料:

奇美达包覆式密封条, 选用高回弹的聚氨酯泡沫内芯, 高韧性聚乙烯外膜, PP骨架及TPV塑料倒钩完美结合。

Material:

CHIMEDA PU foam sealing strip, use high-resilience polyurethane foam inner core, high-toughness polyethylene outer film and is perfectly combined with PP skeleton and TPV plastic barbs.

性能:

10%以下的压缩变形
-40°C至90°C的耐候性
户外20年以上的耐老化性
模仿门窗开关50万次外形无明显变化的耐疲劳性
提高门窗35%的隔音性能

Performance:

It features compression deformation below 10%
Weather resistance from -40 °C to 90 °C
Outdoor aging resistance for more than 20 years
Fatigue resistance with no obvious change in shape after 500000 times of imitated open-close of doors and windows
Improve the sound insulation performance of doors and windows by 35%

颜色:

黑色、白色、灰色、棕色、米黄、红色

Color:

Black /White /Grey /Brown /Beige /Red

包装:

1. 卷式包装, 2-3卷/箱
2. 条式包装, 根据客户长度要求截根, 装箱

Packing:

1. Roll packing, 2-3 rolls/carton
2. Strip packing, cut to length according to customer requirements and pack into cartons



PU包覆密封条-自粘式:KMT-M1511

PU Foam sealing strip-Self Adhesive

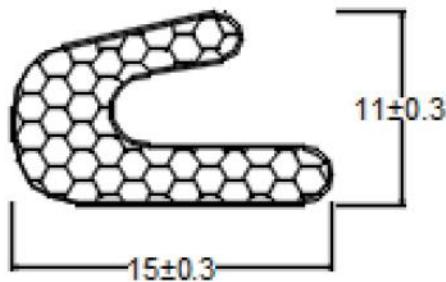

材料:

奇美达包覆式密封条,选用高回弹的聚氨酯泡沫内芯,高韧性聚乙烯外膜,以及高粘度,易撕拉的优质3M背胶制成。

Material:

CHIMEDA PU foam sealing strip, uses high-resilience polyurethane foam inner core, high-toughness polyethylene outer film, and is made of 3M backing adhesive with high-viscosity and easy-to-tear.

性能:

10%以下的压缩变形
-40℃至90℃的耐候性
户外20年以上的耐老化性
模仿门窗开关50万次外形无明显变化的耐疲劳性
提高门窗35%的隔音性能

Performance:

It features compression deformation below 10%
Weather resistance from -40 °C to 90 °C
Outdoor aging resistance for more than 20 years
Fatigue resistance with no obvious change in shape after 500000 times of imitated open-close of doors and windows
Improve the sound insulation performance of doors and windows by 35%

颜色:

黑色、白色、灰色、棕色、米黄、红色

Color:

Black /White /Grey /Brown /Beige /Red

包装:

- 1.卷式包装, 2-3卷/箱
- 2.条式包装, 根据客户长度要求截根, 装箱

Packing:

1. Roll packing, 2-3 rolls/carton
- 2.Strip packing, cut to length according to customer requirements and pack into cartons



PU包覆密封条-自粘式:KMT-M0413

PU Foam sealing strip-Self Adhesive

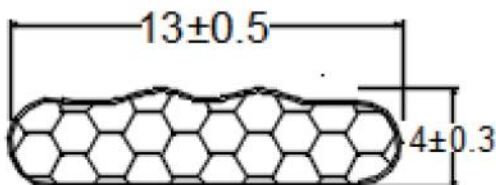

材料:

奇美达包覆式密封条,选用高回弹的聚氨酯泡沫内芯,高韧性聚乙烯外膜,以及高粘度,易撕拉的优质3M背胶制成。

Material:

CHIMEDA PU foam sealing strip, uses high-resilience polyurethane foam inner core, high-toughness polyethylene outer film, and is made of 3M backing adhesive with high-viscosity and easy-to-tear.

性能:

10%以下的压缩变形
-40℃至90℃的耐候性
户外20年以上的耐老化性
模仿门窗开关50万次外形无明显变化的耐疲劳性
提高门窗35%的隔音性能

Performance:

It features compression deformation below 10%
Weather resistance from -40 °C to 90 °C
Outdoor aging resistance for more than 20 years
Fatigue resistance with no obvious change in shape after 500000 times of imitated open-close of doors and windows
Improve the sound insulation performance of doors and windows by 35%

颜色:

黑色、白色、灰色、棕色、米黄、红色

Color:

Black /White /Grey /Brown /Beige /Red

包装:

- 1.卷式包装,2-3卷/箱
- 2.条式包装,根据客户长度要求截根,装箱

Packing:

1. Roll packing, 2-3 rolls/carton
- 2.Strip packing, cut to length according to customer requirements and pack into cartons



磁吸静音密封条:KMT-CX006 Magnetic Silent Sealing Strip

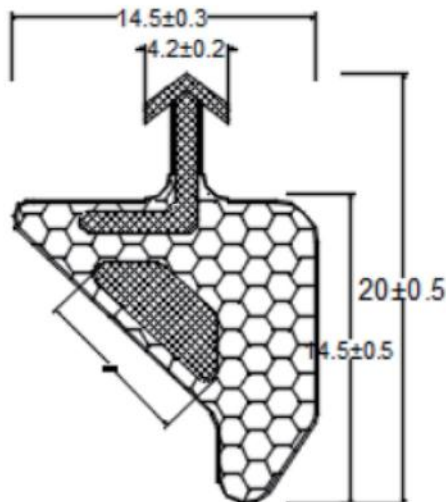

材料:

奇美达磁吸静音密封条,用于室内木门门框密封,采用高回弹聚氨酯泡沫内芯,高韧性聚乙烯外膜,PP骨架及TPV塑料倒钩完美结合,选用强力磁吸条,当门扇接近门框时,由于门扇与门框间磁吸条的吸力,使门自动关闭。

Material:

CHIMEDA magnetic silent sealing strip, used for wooden door frames sealing, uses high-resilience polyurethane foam inner core, high-toughness polyethylene outer film, PP skeleton and TPV plastic barbs perfectly combined and uses strong magnetic strips. When the door leaf approaches the door frame, the door automatically closes due to the suction of the magnetic strip between the door leaf and the door frame.

性能:

10%以下的压缩变形

-40°C至90°C的耐候性

户外20年以上的耐老化性

模仿门窗开关50万次外形无明显变化的耐疲劳性

提高门窗35%的隔音性能

Performance:

It is featured compression deformation below 10%

Weather resistance from -40 °C to 90 °C

Outdoor aging resistance for more than 20 years

Fatigue resistance with no obvious change in shape after 500000 times of imitated open-close of doors and windows

Improve the sound insulation performance of doors and windows by 35%

颜色:

黑色、白色、灰色、棕色、米黄、红色

Color:

Black /White /Grey /Brown /Beige /Red

包装:

条式包装,根据客户长度要求截根,装箱

Packing:

Strip packaging, cut to length according to customer requirements and pack into carton



磁吸静音密封条:KMT-CX004 Magnetic Silent Sealing Strip

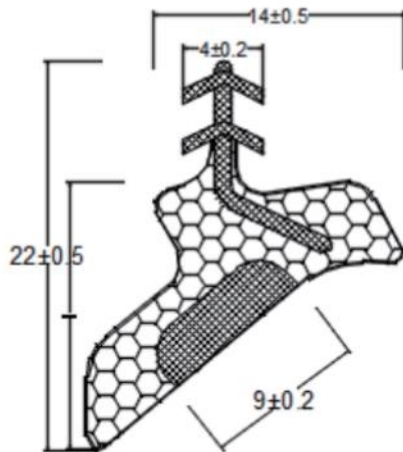

材料:

奇美达磁吸静音密封条,用于室内木门门框密封,采用高回弹聚氨酯泡沫内芯,高韧性聚乙烯外膜,PP骨架及TPV塑料倒钩完美结合,选用强力磁吸条,当门扇接近门框时,由于门扇与门框间磁吸条的吸力,使门自动关闭。

Material:

CHIMEDA magnetic silent sealing strip, used for wooden door frames sealing, uses high-resilience polyurethane foam inner core, high-toughness polyethylene outer film, PP skeleton and TPV plastic barbs perfectly combined and uses strong magnetic strips. When the door leaf approaches the door frame, the door automatically closes due to the suction of the magnetic strip between the door leaf and the door frame.

性能:

10%以下的压缩变形

-40°C至90°C的耐候性

户外20年以上的耐老化性

模仿门窗开关50万次外形无明显变化的耐疲劳性

提高门窗35%的隔音性能

Performance:

It is featured compression deformation below 10%

Weather resistance from -40 °C to 90 °C

Outdoor aging resistance for more than 20 years

Fatigue resistance with no obvious change in shape after 500000 times of imitated open-close of doors and windows

Improve the sound insulation performance of doors and windows by 35%

颜色:

黑色、白色、灰色、棕色、米黄、红色

Color:

Black /White /Grey /Brown /Beige /Red

包装:

条式包装,根据客户长度要求截根,装箱

Packing:

Strip packaging, cut to length according to customer requirements and pack into carton

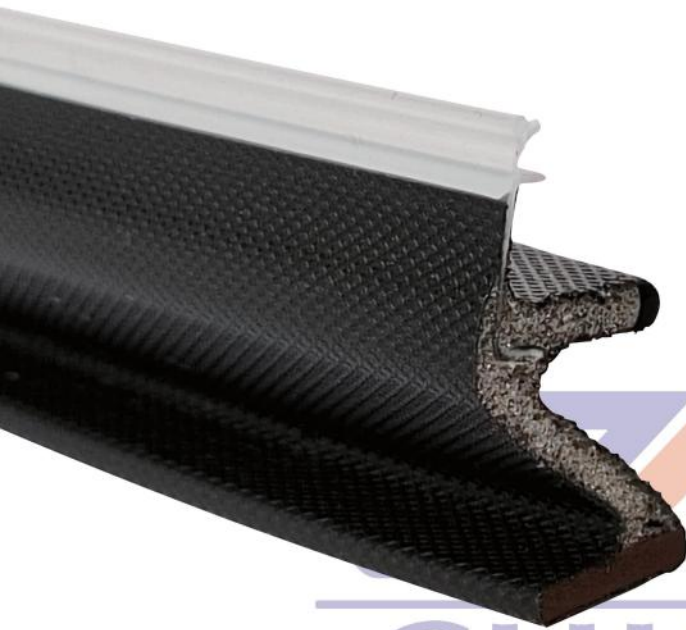

磁吸静音密封条:KMT-CX003 Magnetic Silent Sealing Strip

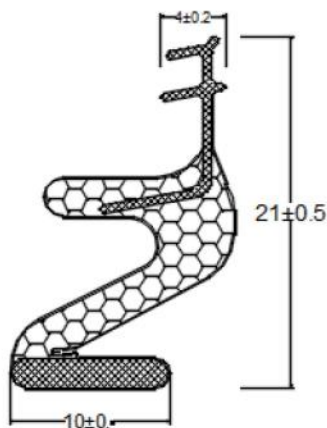

材料:

奇美达磁吸静音密封条,用于室内木门门框密封,采用高回弹聚氨酯泡沫内芯,高韧性聚乙烯外膜,PP骨架及TPV塑料倒钩完美结合,选用强力磁吸条,当门扇接近门框时,由于门扇与门框间磁吸条的吸力,使门自动关闭。

Material:

CHIMEDA magnetic silent sealing strip, used for wooden door frames sealing, uses high-resilience polyurethane foam inner core, high-toughness polyethylene outer film, PP skeleton and TPV plastic barbs perfectly combined and uses strong magnetic strips. When the door leaf approaches the door frame, the door automatically closes due to the suction of the magnetic strip between the door leaf and the door frame.

性能:

10%以下的压缩变形

-40°C至90°C的耐候性

户外20年以上的耐老化性

模仿门窗开关50万次外形无明显变化的耐疲劳性

提高门窗35%的隔音性能

Performance:

It is featured compression deformation below 10%

Weather resistance from -40 °C to 90 °C

Outdoor aging resistance for more than 20 years

Fatigue resistance with no obvious change in shape after 500000 times of imitated open-close of doors and windows

Improve the sound insulation performance of doors and windows by 35%

颜色:

黑色、白色、灰色、棕色、米黄、红色

Color:

Black /White /Grey /Brown /Beige /Red

包装:

条式包装,根据客户长度要求截根,装箱

Packing:

Strip packaging, cut to length according to customer requirements and pack into carton



PU包覆密封条-卡槽式:KMT-C0508

PU Foam sealing strip- slot type

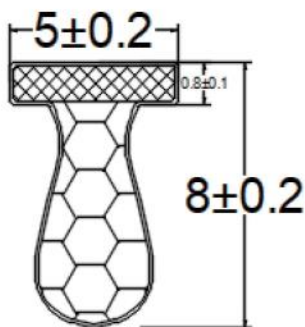

材料:

奇美达包覆式密封条, 选用高回弹的聚氨酯泡沫内芯, 高韧性聚乙烯外膜, PP骨架及TPV塑料倒钩完美结合。

Material:

CHIMEDA PU foam sealing strip, use high-resilience polyurethane foam inner core, high-toughness polyethylene outer film and is perfectly combined with PP skeleton and TPV plastic barbs.

性能:

10%以下的压缩变形
-40℃至90℃的耐候性
户外20年以上的耐老化性
模仿门窗开关50万次外形无明显变化的耐疲劳性
提高门窗35%的隔音性能

Performance:

It features compression deformation below 10%
Weather resistance from -40 °C to 90 °C
Outdoor aging resistance for more than 20 years
Fatigue resistance with no obvious change in shape after 500000 times of imitated open-close of doors and windows
Improve the sound insulation performance of doors and windows by 35%

颜色:

黑色、白色、灰色、棕色、米黄、红色

Color:

Black /White /Grey /Brown /Beige /Red

包装:

- 1.卷式包装, 2-3卷/箱
- 2.条式包装, 根据客户长度要求截根, 装箱

Packing:

1. Roll packing, 2-3 rolls/carton
- 2.Strip packing, cut to length according to customer requirements and pack into cartons

材料:

奇美达包覆式密封条, 选用高回弹的聚氨酯泡沫内芯, 高韧性聚乙烯外膜, PP骨架及TPV塑料倒钩完美结合。

Material:

CHIMEDA PU foam sealing strip, use high-resilience polyurethane foam inner core, high-toughness polyethylene outer film and is perfectly combined with PP skeleton and TPV plastic barbs.

性能:

10%以下的压缩变形
-40℃至90℃的耐候性
户外20年以上的耐老化性
模仿门窗开关50万次外形无明显变化的耐疲劳性
提高门窗35%的隔音性能

Performance:

It features compression deformation below 10%
Weather resistance from -40 °C to 90 °C
Outdoor aging resistance for more than 20 years
Fatigue resistance with no obvious change in shape after 500000 times of imitated open-close of doors and windows
Improve the sound insulation performance of doors and windows by 35%

PU包覆密封条-卡槽式:KMT-C0502

PU Foam sealing strip- slot type

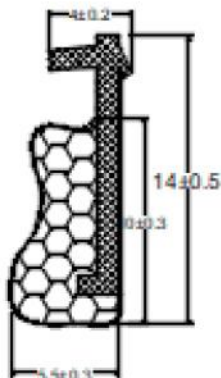

颜色:

黑色、白色、灰色、棕色、米黄、红色

Color:

Black /White /Grey /Brown /Beige /Red

包装:

- 1.卷式包装, 2-3卷/箱
- 2.条式包装, 根据客户长度要求截根, 装箱

Packing:

1. Roll packing, 2-3 rolls/carton
- 2.Strip packing, cut to length according to customer requirements and pack into cartons



材料:

奇美达包覆式密封条,选用高回弹的聚氨酯泡沫内芯,高韧性聚乙烯外膜,以及高粘度,易撕拉的优质3M背胶制成。

Material:

CHIMEDA PU foam sealing strip, uses high-resilience polyurethane foam inner core, high-toughness polyethylene outer film, and is made of 3M backing adhesive with high-viscosity and easy-to-tear.

性能:

10%以下的压缩变形
-40℃至90℃的耐候性
户外20年以上的耐老化性
模仿门窗开关50万次外形无明显变化的耐疲劳性
提高门窗35%的隔音性能

Performance:

It features compression deformation below 10%
Weather resistance from -40 °C to 90 °C
Outdoor aging resistance for more than 20 years
Fatigue resistance with no obvious change in shape after 500000 times of imitated open-close of doors and windows
Improve the sound insulation performance of doors and windows by 35%

PU包覆密封条-自粘式:KMT-M1246

PU Foam sealing strip-Self Adhesive

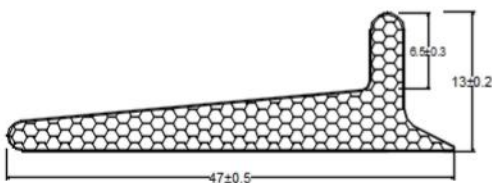

颜色:

黑色、白色、灰色、棕色、米黄、红色

Color:

Black /White /Grey /Brown /Beige /Red

包装:

- 1.卷式包装, 2-3卷/箱
- 2.条式包装, 根据客户长度要求截根, 装箱

Packing:

1. Roll packing, 2-3 rolls/carton
- 2.Strip packing, cut to length according to customer requirements and pack into cartons

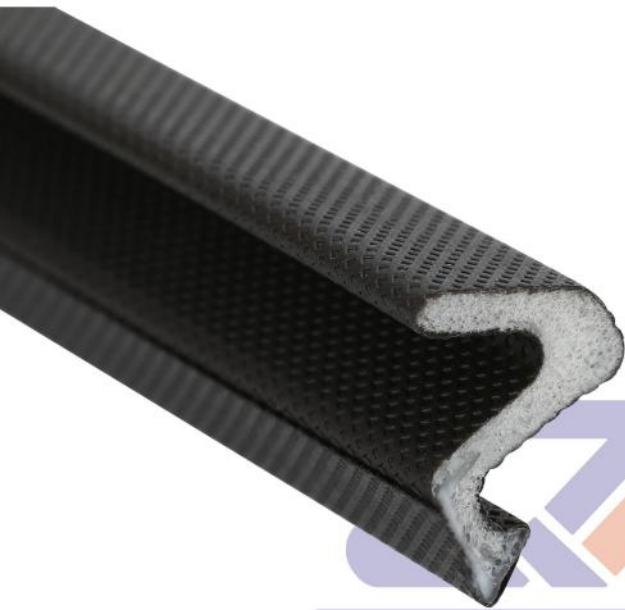

PU包覆密封条-卡槽式:KMT-M1033

PU Foam sealing strip- slot type

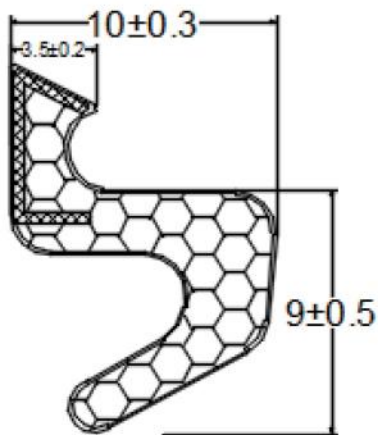

材料:

奇美达包覆式密封条, 选用高回弹的聚氨酯泡沫内芯, 高韧性聚乙烯外膜, PP骨架及TPV塑料倒钩完美结合。

Material:

CHIMEDA PU foam sealing strip, use high-resilience polyurethane foam inner core, high-toughness polyethylene outer film and is perfectly combined with PP skeleton and TPV plastic barbs.

性能:

10%以下的压缩变形
-40℃至90℃的耐候性
户外20年以上的耐老化性
模仿门窗开关50万次外形无明显变化的耐疲劳性
提高门窗35%的隔音性能

Performance:

It features compression deformation below 10%
Weather resistance from -40 °C to 90 °C
Outdoor aging resistance for more than 20 years
Fatigue resistance with no obvious change in shape after 500000 times of imitated open-close of doors and windows
Improve the sound insulation performance of doors and windows by 35%

颜色:

黑色、白色、灰色、棕色、米黄、红色

Color:

Black /White /Grey /Brown /Beige /Red

包装:

- 1.卷式包装, 2-3卷/箱
- 2.条式包装, 根据客户长度要求截根, 装箱

Packing:

1. Roll packing, 2-3 rolls/carton
- 2.Strip packing, cut to length according to customer requirements and pack into cartons

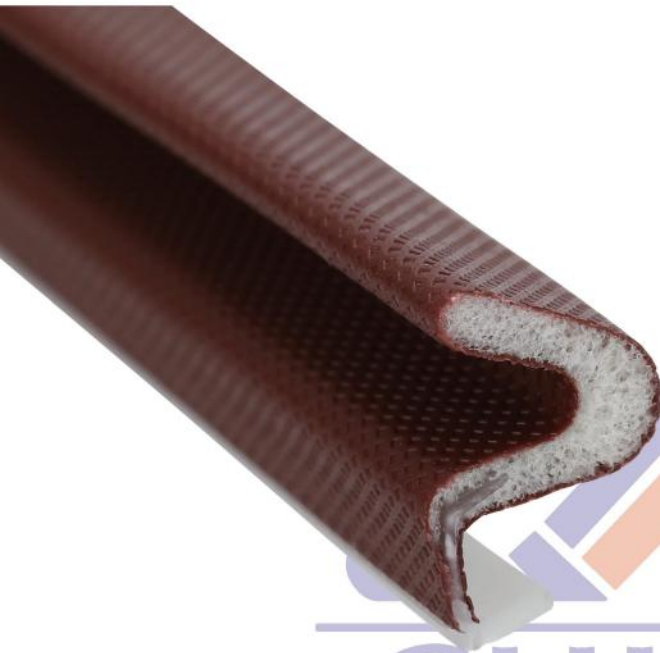

PU包覆密封条-卡槽式:KMT-M1032

PU Foam sealing strip- slot type

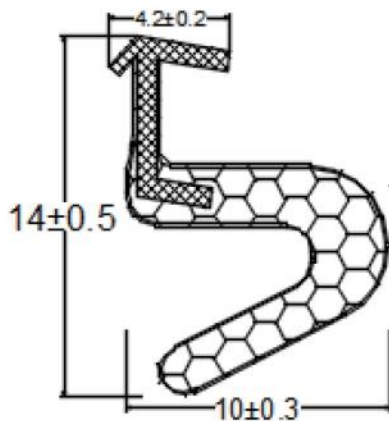

材料:

奇美达包覆式密封条, 选用高回弹的聚氨酯泡沫内芯, 高韧性聚乙烯外膜, PP骨架及TPV塑料倒钩完美结合。

Material:

CHIMEDA PU foam sealing strip, use high-resilience polyurethane foam inner core, high-toughness polyethylene outer film and is perfectly combined with PP skeleton and TPV plastic barbs.

性能:

10%以下的压缩变形
-40℃至90℃的耐候性
户外20年以上的耐老化性
模仿门窗开关50万次外形无明显变化的耐疲劳性
提高门窗35%的隔音性能

Performance:

It features compression deformation below 10%
Weather resistance from -40 °C to 90 °C
Outdoor aging resistance for more than 20 years
Fatigue resistance with no obvious change in shape after 500000 times of imitated open-close of doors and windows
Improve the sound insulation performance of doors and windows by 35%

颜色:

黑色、白色、灰色、棕色、米黄、红色

Color:

Black /White /Grey /Brown /Beige /Red

包装:

- 1.卷式包装, 2-3卷/箱
- 2.条式包装, 根据客户长度要求截根, 装箱

Packing:

1. Roll packing, 2-3 rolls/carton
- 2.Strip packing, cut to length according to customer requirements and pack into cartons